



CO₂ laser consumables – LVD®



Hypertherm®

Highest quality products

- OEM quality
- OEM-approved optics
- 100% satisfaction guarantee

Technical service

OEM-trained technicians on staff with over 25 years of experience.

Free application support for all laser OEMs.

We stand behind our products with industry-leading technical expertise.

Chemical code key

Lens

PFL	Pre-focus
MEN	Meniscus
PLX	Plano-convex
MTD	Mounted
Not MTD	Not mounted
LA	Low absorption
PO	Plano

Mirrors

CU	Copper
GAAS	Gallium arsenide
SI	Silicon
GE	Germanium
ZNSE	Zinc-selenide
PS	Phase shift
MMR	Maximum metal reflector
ATFR	Absorbing thin film reflector
TRZ	Total reflector – zero phase shift
ZPS	Zero phase shift
OC	Output coupler
RM	Rear mirror
COL-I	Collimator input
COL-O	Collimator output
AO	Adaptive optic
MO	Molybdenum
UC	Uncoated
MCX	Convex
MCC	Concave

Measurements

DIA	Diameter
FL	Focal length
ET	Edge thickness

Nozzles

CP	Chrome plated
HD/HP	High density/high pressure

Product is available for the following major OEM brands

Amada®

Behrens®

Bystronic®

Cincinnati®

Finn-Power®

GHT-SHT®

Haas®

Haco®

Hankwang®

Laserdyne®

Laser Lab®

LVD®

Mazak®

Mitsubishi®

Murata Wiedemann® – Fanuc®

Niigata®

NTC® – Beyeler®

Precitec®

Prima Industrie®

Raskin®

Rouchaud®

Salvagnini®

Strippit®

Tanaka®

Thyssen®

Trumpf®

Valfiv®

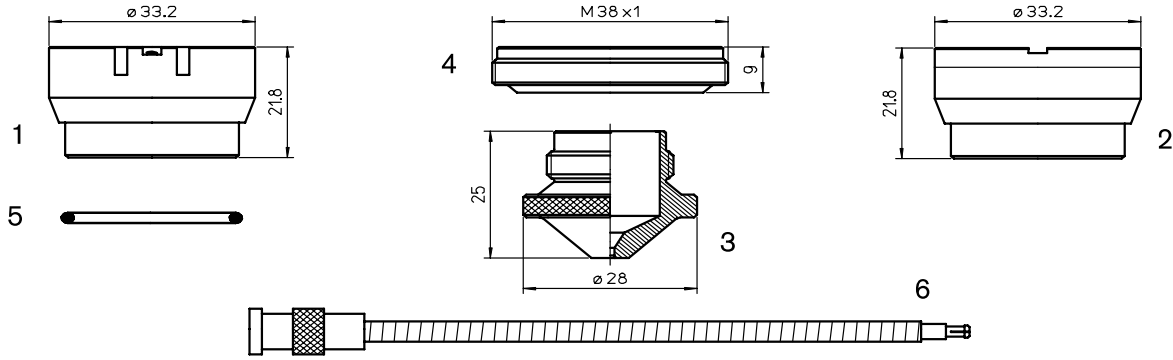

Consumables

	Centricut part number	Reference number	Alternate reference	Description	Pkg qty	
1	PT311-1146	281146, P0380-211-00001, 29100033	AL130/S	Nozzle holder ITM 1.5" DZ	1	
	PT311-1146 OEM	281146, P0380-211-00001, 29100033	AL130	Nozzle holder ITM 1.5" DZ (OEM)	1	
2	PT311-0565	280565, P0497-605-00001, 29100106	AL40	Nozzle holder, KTM 1.5" DXN	1	
	LV332-1993	D5241993	L757	Nozzle – 0.8 mm (cylindrical)	1	
	LV332-5470	D7945470	L141	Nozzle – 1.0 mm (cylindrical)	1	
	LV332-0001	D5241982	L758	Nozzle – 1.2 mm (cylindrical)	1	
	LV332-5434	D7945434	L142	Nozzle – 1.5 mm (cylindrical)	1	
	LV332-5452	D7945452	L143	Nozzle – 2.0 mm (cylindrical)	1	
	LV332-5517	D7945517	L144	Nozzle – 2.5 mm (cylindrical)	1	
	LV332-0002		L145	Nozzle – 3.0 mm (cylindrical)	1	
	LV332-1993CP	D5241993	L757X	Nozzle – 0.8 mm CP (cylindrical)	1	
	LV332-5470CP	D7945470	L141X	Nozzle – 1.0 mm CP (cylindrical)	1	
3	LV332-0001CP	D5241982	L758X	Nozzle – 1.2 mm CP (cylindrical)	1	
	LV332-5434CP	D7945434	L142X	Nozzle – 1.5 mm CP (cylindrical)	1	
	LV332-5452CP	D7945452	L143X	Nozzle – 2.0 mm CP (cylindrical)	1	
	LV332-5517CP	D7945517	L144X	Nozzle – 2.5 mm CP (cylindrical)	1	
	LV332-0002CP		L145X	Nozzle – 3.0 mm CP (cylindrical)	1	
	4	PT347-4297	P0492-702-00001, 29100021	AL198	Insulating ring	1
		PT311-0001	P0492-702-00002	AL201	Insulating ring	1
5	AM326-6453	71366453	AL94	Outer nozzle o-ring	1	
6	PT347-0101	P0360-100-00500, 46713300100	AL204	Sensor cable 500 mm KE (OEM)	1	
	PT347-0450	P0497-002-00450	AL202	Sensor cable 450 mm (OEM)	1	

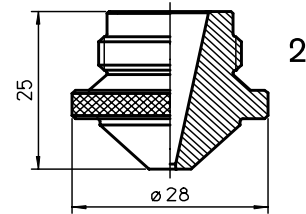
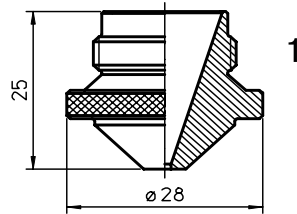

Consumables

Centricut part number	Reference number	Alternate reference	Description	Pkg qty
LV332-1863	D5241863	L151	Nozzle – 1.0 mm HD (conical)	1
LV332-1982	D5241982	L759	Nozzle – 1.2 mm HD (conical)	1
LV332-1862	D5241862	L152	Nozzle – 1.5 mm HD (conical)	1
LV332-2512	D5242512	L748	Nozzle – 1.7 mm HD (conical)	1
LV332-1855	D5241855	L146	Nozzle – 2.0 mm HD (conical)	1
LV332-2513	D5242513	L749	Nozzle – 2.3 mm HD (conical)	1
LV332-1856	D5241856	L147	Nozzle – 2.5 mm HD (conical)	1
LV332-1857	D5241857	L148	Nozzle – 3.0 mm HD (conical)	1
LV332-1877	D5241877	L149	Nozzle – 3.5 mm HD (conical)	1
LV332-1878	D5241878	L283	Nozzle – 4.0 mm HD (conical)	1
LV332-2531	D5242531	L1303	Nozzle – 4.5 mm HD (conical)	1
1 LV332-2535	D5242535	L1304	Nozzle – 5.0 mm HD (conical)	1
LV332-2536	D5242536	L1305	Nozzle – 6.0 mm HD (conical)	1
LV332-1863CP	D5241863	L151X	Nozzle – 1.0 mm HD CP (conical)	1
LV332-1982CP		L759X	Nozzle – 1.2 mm HD CP (conical)	1
LV332-1862CP	D5241862	L152X	Nozzle – 1.5 mm HD CP (conical)	1
LV332-2512CP	D5242512	L748X	Nozzle – 1.7 mm HD CP (conical)	1
LV332-1855CP	D5241855	L146X	Nozzle – 2.0 mm HD CP (conical)	1
LV332-2513CP	D5242513	L749X	Nozzle – 2.3 mm HD CP (conical)	1
LV332-1856CP	D5241856	L147X	Nozzle – 2.5 mm HD CP (conical)	1
LV332-1857CP	D5241857	L148X	Nozzle – 3.0 mm HD CP (conical)	1
LV332-1877CP	D5241877	L149X	Nozzle – 3.5 mm HD CP (conical)	1
LV332-1878CP	D5241878	L283X	Nozzle – 4.0 mm HD CP (conical)	1
LV332-2453	D5242453A	L152-S	Nozzle – 1.5 mm HD	1
2 LV332-2454	D5242454A	L146-S	Nozzle – 2.0 mm HD	1
LV332-2416	D5242416A	L147-S	Nozzle – 2.5 mm HD	1
LV332-2455	D5242455 A	L148-S	Nozzle – 3.0 mm HD	1

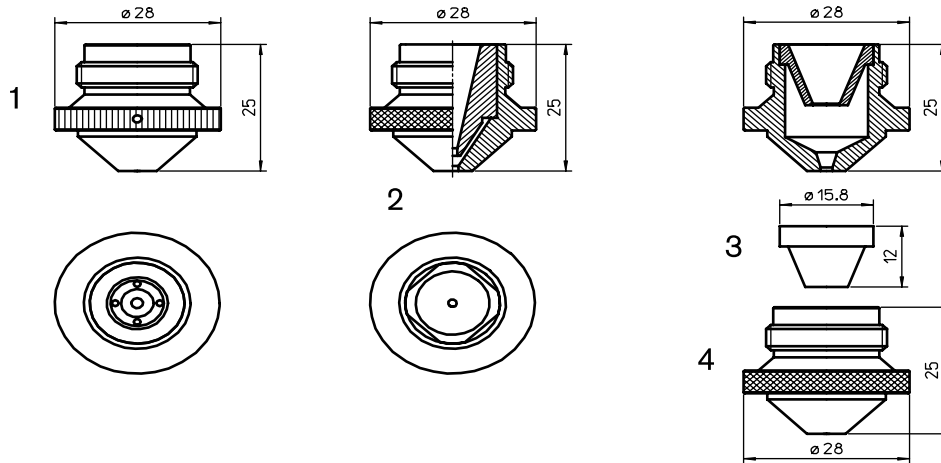

Consumables

Centricut part number	Reference number	Alternate reference	Description	Pkg qty
1 LV332-0013	G8040180	L1290	Nozzle – 2.5 mm double w/spring 1.3 mm inner	1
LV332-0180	G8040135	L1291	Nozzle – 2.5 mm double w/spring 1.5 mm inner	1
LV332-3013	G8040182	L1293	Nozzle – 3.0 mm double w/spring 1.3 mm inner	1
LV332-3015		L1294	Nozzle – 3.0 mm double w/spring 1.5 mm inner	1
LV332-0132	G8040132	L1292	Nozzle – 3.0 mm double w/spring 2.0 mm inner	1
LV332-0013CP	G8040180	L1290X	Nozzle – 2.5 mm double w/spring 1.3 mm inner CP	1
LV332-0180CP	G8040135	L1291X	Nozzle – 2.5 mm double w/spring 1.5 mm inner CP	1
LV332-3013CP	G8040182	L1293X	Nozzle – 3.0 mm double w/spring 1.3 mm inner CP	1
LV332-3015CP		L1294X	Nozzle – 3.0 mm double w/spring 1.5 mm inner CP	1
LV332-0132CP	G8040132	L1292X	Nozzle – 3.0 mm double w/spring 2.0 mm inner CP	1
2 LV417-0001	Centricut design	L783	Nozzle – 1.0 mm double	1
LV417-0002	Centricut design	L782	Nozzle – 1.2 mm double	1
LV417-0003	Centricut design	L784	Nozzle – 1.5 mm double	1
LV417-0004	Centricut design	L785	Nozzle – 2.0 mm double	1
LV410-0180	Centricut design	L786	Nozzle – 2.5 mm double	1
LV417-0006	Centricut design	L787	Nozzle – 3.0 mm double	1
LV417-0007	Centricut design	L788	Nozzle – 3.5 mm double	1
LV417-0008	Centricut design	L789	Nozzle – 4.0 mm double	1
LV417-0001CP	Centricut design	L783X	Nozzle – 1.0 mm double CP	1
LV417-0002CP	Centricut design	L782X	Nozzle – 1.2 mm double CP	1
LV417-0003CP	Centricut design	L784X	Nozzle – 1.5 mm double CP	1
LV417-0004CP	Centricut design	L785X	Nozzle – 2.0 mm double CP	1
LV417-0005CP	Centricut design	L786X	Nozzle – 2.5 mm double CP	1
LV417-0006CP	Centricut design	L787X	Nozzle – 3.0 mm double CP	1
LV417-0007CP	Centricut design	L788X	Nozzle – 3.5 mm double CP	1
LV417-0008CP	Centricut design	L789X	Nozzle – 4.0 mm double CP	1
LV332-0131 (not shown)	G8040131	L790	Nozzle – 3.0 mm double	1
3 LV418-0001	Centricut design	L157	Nozzle, inner	1
LV418-0010	Centricut design	L158	Nozzle – 1.0 mm	1
LV418-0003	Centricut design	L934	Nozzle – 1.2 mm	1
LV418-0004	Centricut design	L159	Nozzle – 1.5 mm	1
4 LV418-0005	Centricut design	L160	Nozzle – 2.0 mm	1
LV418-0006	Centricut design	L161	Nozzle – 2.5 mm	1
LV418-0007	Centricut design	L178	Nozzle – 3.0 mm	1
LV418-0008	Centricut design	L179	Nozzle – 3.5 mm	1

Optics

Centricut part number	Reference number	Type	Diameter	Focal length	Edge thickness
Lenses					
LV333-0023	29100023	MEN	1.5"	5.0"	.290"
LV333-6326	206326	MEN	2.0"	5.0"	.354"
LV333-1004	458138	MEN	2.0"	5.0"	.380"
LV333-1005	291005-5	MEN	2.0"	7.5"	.380"
LV333-0176	480176	MEN	1.75"	5.0"	.354"
LV333-1551	981551	MEN	2.0"	10.0"	.380"
Ultra low absorption lenses					
LV333-0023MP5	29100023	MEN	1.5"	5.0"	.290"
LV333-1005MP5	291005-5	MEN	1.5"	7.5"	.380"

Centricut part number	Reference number	Material	Diameter	Edge thickness	S1/Reflectivity	S2
Output couplers						
LV333-7295	897295	ZNSE	1.5"	.315"	30MCC-50%	

Centricut part number	Reference number	Material	Diameter	Edge thickness	S1/Reflectivity	S2
Rear mirrors						
LV333-6659	966659	GE	1.5"	.315"	30MCC-99.5%	

Optics care

Centricut part number	Reference number	Description	Pkg qty
TR300-6452	N/A	CO ₂ Lens paper (50 sheets)	1
TR300-SC20		Cotton swab – 20 piece	1
TR300-1115		Lens cleaning pre-cut cotton –100 piece	1
TR300-1010	AL1010	Dropper, lens cleaning fluid	1
TR300-255	AL255	Loupe, magnifying	1
TR300-271	AL271	Base, lens maintenance	1
TR300-7388	787388	Mirror polish (250 ml)	1

New items shown in bold



Broadest product line in the industry!



Hypertherm, Inc.
Hanover, NH 03755 USA
603-643-3441 Tel

Hypertherm Europe B.V.
4704 SE Roosendaal, Nederland
31 165 596907 Tel

**Hypertherm (Shanghai)
Trading Co., Ltd.**
PR China 200052
86-21 5258 3330 /1 Tel

Hypertherm (S) Pte Ltd.
Singapore 349567
65 6 841 2489 Tel

**Hypertherm (India) Thermal
Cutting Pvt. Ltd.**
Chennai, Tamil Nadu
91 0 44 2834 5361 Tel

Hypertherm Brasil Ltda.
Guarulhos, SP - Brasil
55 11 2409 2636 Tel

Hypertherm México, S.A. de C.V.
México, D.F.
52 55 5681 8109 Tel

www.hypertherm.com



Hypertherm[®]

Cut with confidence[®]